



## 40/170 Spit Road Mosman NSW

1 1 1

Embrace the charm of Mosman with this exceptional property. Nestled in one of Sydney's most coveted suburbs, this stylish apartment offers stunning views.

Whether you are relaxing on your private balcony or entertaining guests - this tastefully finished top-floor apartment is located at the rear of the block, boasting panoramic views of the City, North Sydney, Chatswood, St Leonards, and Middle Harbour. Featuring a spacious living area, contemporary kitchen with updated appliances, and large bedroom with ample storage.

Positioned just moments from vibrant shops, cafes, and restaurants, this property offers ultimate convenience and

[For full version visit the website](https://www.eliasproperty.com.au)

**Type** : Apartment  
**Land Size** : 75 sqm  
**View** : <https://www.eliasproperty.com.au/sale/nsw/north-shore-lower/mosman/residential/apartment/8131750>



**Ella Elias**  
02 9807 3688



**Annabelle Navybox**  
02 9807 3688

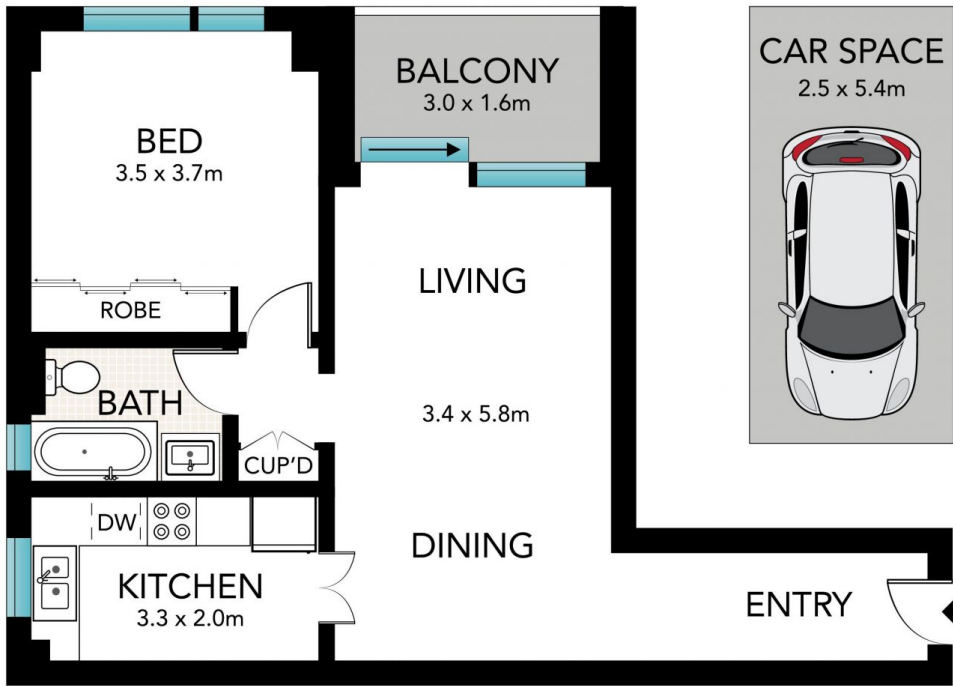

**LEVEL EIGHT**



Scale in metres. Indicative only. Dimensions are approximate. All information contained herein is gathered from sources we believe to be reliable. However, we cannot guarantee its accuracy and interested persons should rely on their own enquiries.



40/170 Spit Road, Mosman

